

SPECIFICATIONS	
Frequency Range	9.60 MHz to 32.00 MHz
Frequency Stability over Temp Range	±2.5 ppm OVER -30 C TO +75 C
Frequency Stability Over Supply Voltage Variation	0.2 ppm @ 5.0 V 5% / 0.2 ppm @ 3.0 V 5%
Frequency Stability Over Load Variation	±0.3 ppm @ 10 KOHM // 10pF
Aging	±1.0 ppm Per Year Max.
Operable Temperature Range	-40 C TO +85 C
Input Voltage	+5.0VDC 5% VDC OR +3.0 VDC 5% VDC
Input Current	2.0 mA Max. (9.60 MHZ TO 19.999 MHZ) 3.0 mA Max. (20.00 MHZ TO 32.00 MHZ)
Output Waveform	Clipped Sinewave
Output Level	1.0 V P-P FOR +5.0 VDC 5% 0.8 V P-P FOR +3.0 VDC 5%
Output Load	10 K OHM // 10PF
Frequency Deviation	4: 4.5 ppm to 7.5 ppm @ +1.5 V 1.0 VDC 8: 8 ppm to 15 ppm @ +2.5 V 2.0 VDC
Frequency Adjustment	3 ppm Min. by internal trimmer

All measurements: MM

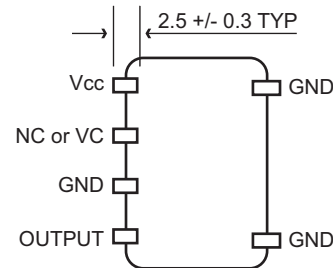
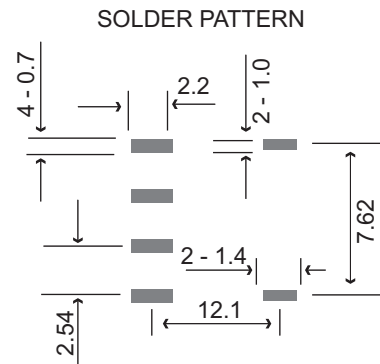
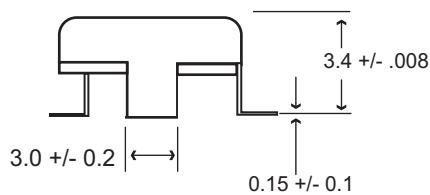
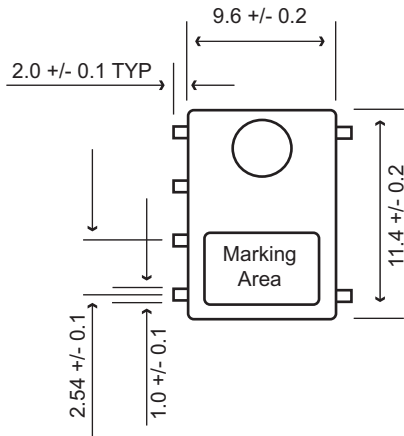

CDI Part Number Guide

CDI-TV911	FT	1	T	?	S	12M8000	TR
CDI Prefix	Temp Range	Voltage	Trimmer	Frequency Deviation	Waveform	Frequency	Tape & Reel
	FT: -30° C TO +80° C	1: +5.0V 2: +3.0V	T: Trimmer	4: ±4.5 ppm to ±7.5 ppm 8: ±8 ppm to ±15 ppm	S: Clipped Sine		TR